

SWAGBOARD™
ELECTRIC LONGBOARD

Voyager



USER MANUAL

Thank you for your purchase of the Swagboard Voyager Electric Longboard by SWAGTRON™!

Get ready to experience the excitement of traveling in an all new way. The Swagboard™ takes the fun of a skateboard, adds an electric motor and LFP Battery, and tops it off with an extra bit of swag.

To ensure your safety and the safety of others, please read and follow the guidelines in this User Manual carefully before riding.

If you have any questions regarding the Swagboard™, contact us at 1-844-299-0625 for further assistance.

Happy Riding!

-The SWAGTRON™ Team.

Contents

Section 1 - Overview	—	5	3.4 - Auto Shutdown	—	13
1.1 - What's in the Box?	—	5	3.5 - Cruise Control	—	13
1.2 - Swagboard Overview	—	5	Section 4 - Battery	—	14
1.3 - Swagboard Specifications	—	6	4.1 - Battery Specification	—	14
Section 2 - Remote Control	—	7	4.2 - Charging the Swagboard	—	14
2.1 - Quick Start	—	8	Section 5 - Safety Notice	—	15
2.2 - LCD Screen	—	9	5.1 - Safe Riding Techniques	—	15
Section 3 - Usage and Instructions	—	10	5.2 - Battery Safety Usage Warnings	—	17
3.1 - Connecting	—	11	Section 6 - Important Information	—	18
3.2 - Acceleration / Deceleration Buttons	—	11	6.1 - DISPOSAL AT END-OF-LIFE	—	20
3.3 - Throttle	—	12	1 Year Limited Hardware Warranty	—	20

Section 1 - Overview

Please read the user manual in its entirety before using the skateboard so that you may fully understand its parts and functions and be able to operate it safely.

1.1 - What's in the Box?

- + Swagboard Voyager Electric Longboard
- + Remote Control
- + Wrist Strap
- + User Manual
- + Charging Adapter (For the Skateboard)
- + Micro USB Charging Cable (For the remote)

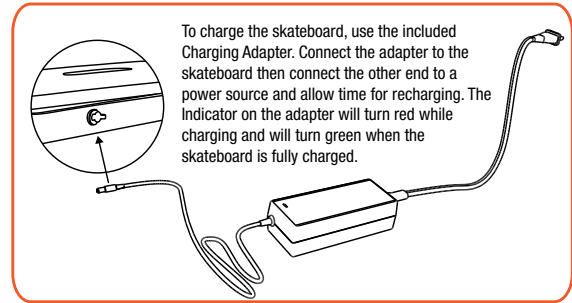

1.2 - Swagboard Overview

- | | |
|---|------------------------|
| ① Front Wheel | ④ Charging Port |
| ② Control Box
(Patented SentryShield
design with LFP Battery) | ⑤ Power Button |
| ③ Grip | ⑥ Rear Motorized Wheel |



1.3 – Swagboard Specifications

	Items	Parameters
Performance	Top Speed	15.5 MPH (25 km/h)
	Mileage per Charge	4 – 15.5 mi (6.4 – 25 km)
	Maximum Load	<150KG (<330lbs)
	Actual Dimensions	41.25 x 8.66 x 5.75 in (1048 x 220 x 146 mm)
	Charging Time	3–4 hrs.
	Connectivity Range	29.5 ft / 9 m
Parts	Net Weight	19.24 lbs. / 8.7 kg
	Deck	8-ply deck with 6 layers of Canadian Maple between 2 layers of Bamboo
	Passive Wheels	PU (Polyurethane)
	Motorized Wheels	Rubber, 36V
	Battery	36V Lithium Iron Phosphate
	Charger	UL DC42V 2A
	Control box	Aluminum Alloy Housing Patented SentryShield design with LFP Battery

Section 2 – Remote Control

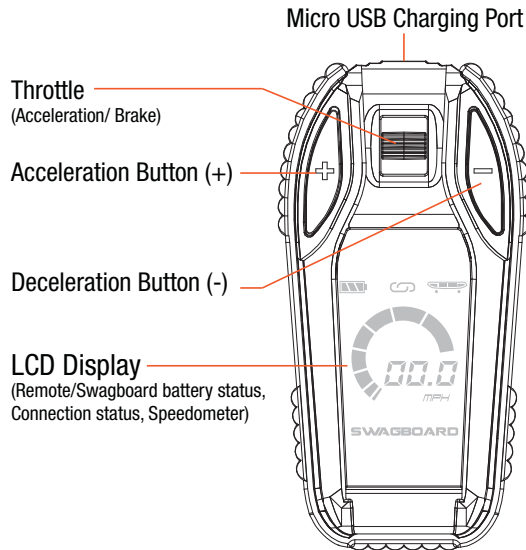

Front View

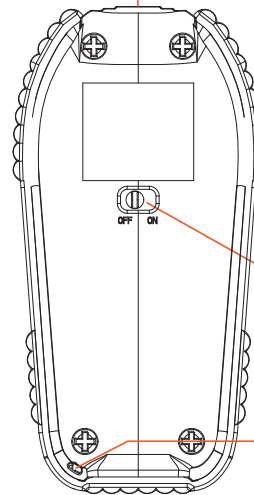

Rear View

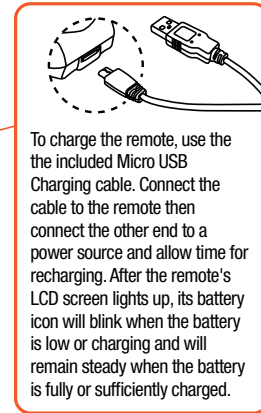

2.1 - Quick Start

Power Switch

Slide the Power Switch left to right to turn the remote on.



Throttle

Push the Throttle up to move forward and/or accelerate. Push it down to brake and/or decelerate.



WARNING FOR BEGINNERS:

Before starting, be sure you understand how to stop.

There are 4 ways to stop for beginners. In order of ease:

- 1) Foot Push: This involves jumping off the board and pushing the board backwards with your lead foot when hopping off.*
- 2) Foot Stepping: Put a hand on your lead knee to brace yourself then use your non-lead foot to step on the ground repeatedly.*
- 3) Foot Dragging: Put both hands on your lead knee to brace yourself, step off the board with your non-lead foot and drag it across the pavement.*
- 4) Rough Drag: Lean toward back of the skateboard and ride into grass or any soft surface.*

2.2 – LCD Screen

Swagboard Battery Icon

Swagboard battery status is divided into multiple levels. The number of levels will decrease as the skateboard's power decreases. When the battery is low, this icon will flicker. When the battery is sufficiently charged, this icon will remain steady. *Note: Use only the charging adapter included in the original packaging.

Remote Battery Icon

Remote battery status is divided into three levels. The number of levels will decrease as remote's power decreases. When the battery is low, this icon will flicker. When the battery is sufficiently charged, this icon will remain steady. *Note: Use only the Micro USB charging cable included in the original packaging.

Pairing Status Icon

This icon indicates the pairing status

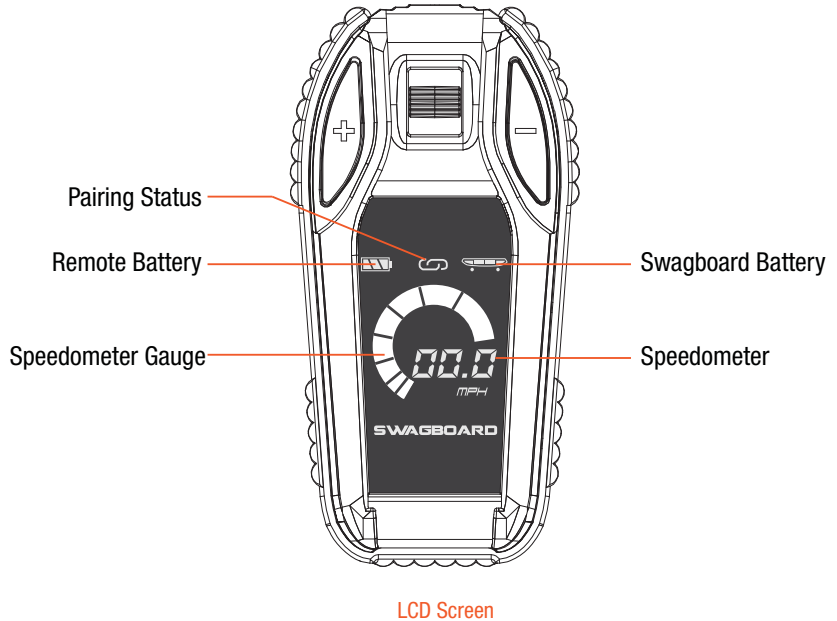

*** Power Saving Function: After 10 seconds of non-use, the remote will enter standby mode automatically. To use it again, press any button to exit standby mode. Note, pushing the throttle will not end standby mode.*

between the Swagboard and the remote. After the two successfully pair, the icon will remain steady. If the pairing is unsuccessful, the icon will flash.

Speedometer

This area will display values according to the current speed.

Speedometer Gauge

This area will display current speed level. There are 9 total levels programmed on the Swagboard. The number of levels will increase and decrease as the throttle or accelerate and decelerate buttons are used. *Note: Value changes may be delayed while using the throttle instead of the accelerate and decelerate buttons.

Section 3 – Usage and Instructions

Ensure the Swagboard is fully or suitably charged and place it down so that the Control Box is facing the ground before using the remote or skateboard.

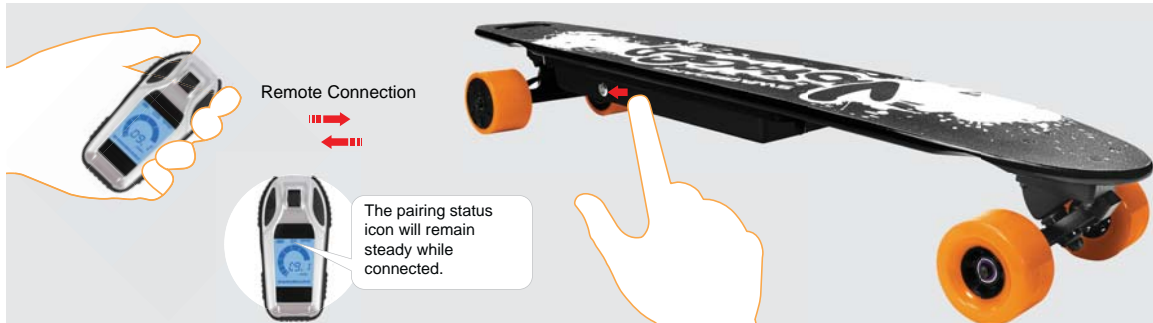

3.1 – Connecting

Before the Swagboard can be fully used, it must be wirelessly connected to the remote. By default, the Swagboard had been pre-paired to the associated remote included in the package. After turning on the Swagboard and the remote, both will automatically connect. If the automatic connection is successful, the Pairing status icon will remain steady on the remote.

If an automatic connection fails, restart the Swagboard then long press both the left and right buttons on your remote (Acceleration and Deceleration Buttons) for approximately 5 seconds. This will permanently associate the skateboard and remote unless these buttons are pressed again for another 5 second duration to cancel.

3.2 – Acceleration / Deceleration Buttons

Acceleration Button is located at the LEFT side of the throttle and features an embossed “+” mark. Press multiple times to increase speed incrementally or press and hold to rapidly increase to the maximum speed.

Deceleration Button is located at the RIGHT side of the throttle and features an embossed “-” mark. Press multiple times to decrease speed incrementally or press and hold to rapidly decrease to stop.

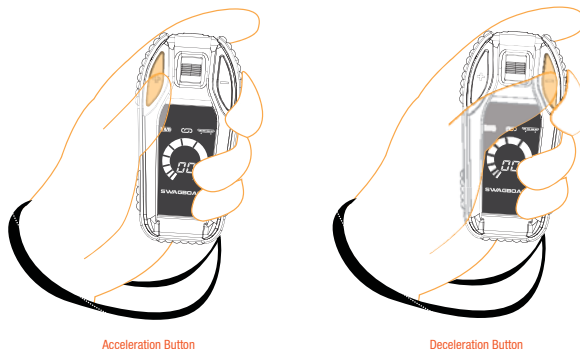

3.3 – Throttle

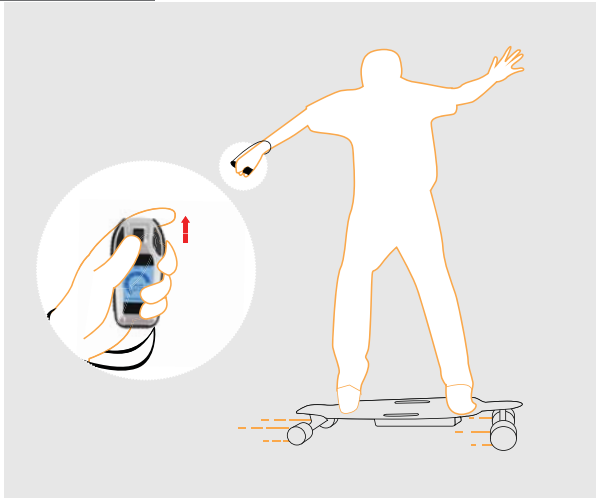

Push the Throttle up to move forward and/or accelerate. The speed at which the skateboard accelerates depends on how far up you push the Throttle i.e. pushing it slightly up will cause the skateboard to accelerate slower compared to pushing it farther up.

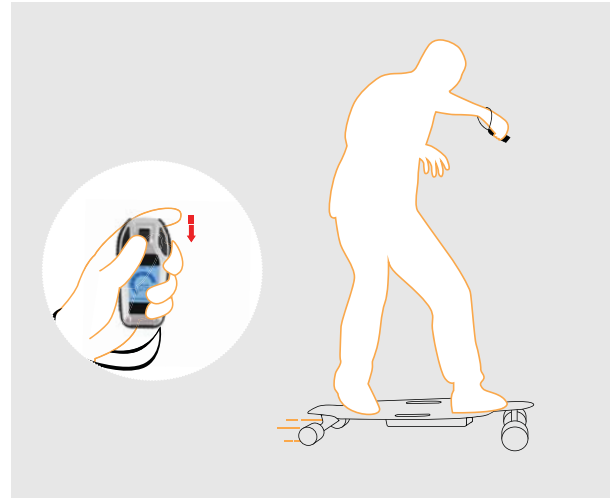

Push the Throttle down to brake and/or decelerate. The speed at which the skateboard decelerates depends on how far down you push the Throttle i.e. pushing it slightly down will cause the skateboard to decelerate slower compared to pushing it farther down.

Note: Before riding, familiarize yourself with how to safely perform manual braking. See the notes on section 2.1.

3.4 – Auto Shutdown

When not in use for approximately 10 minutes, the remote and skateboard will each turn off automatically. To use them once again, simply turn them back on.

3.5 – Cruise Control

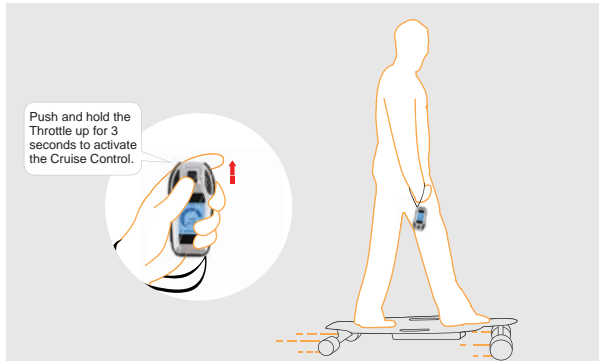

The Swagboard may be made to continue moving at its current speed with no need to hold down any buttons or switches.

To activate Cruise Control:

Step 1. Push and hold the Throttle up for approximately 3 seconds.

Step 2. Let go of the Throttle and the Swagboard will continue to move.

To deactivate Cruise Control:

Step 1. Push the Throttle down slightly.



WARNING:

Before using this feature, be sure you understand how to turn it on and off.



WARNING:

Cruise Control will be deactivated if the skateboard or remote loses power, or if the connection between skateboard and remote is lost.

Section 4 – Battery

4.1 – Battery Specification

Items	Parameters
Battery Type	LFP Battery
Charging Time	3–4 hrs.
Voltage	38.4V
Weight	1.2 kgs
Working Temperature	5°F ~ 122°F (-15°C ~ 50°C)
Charging Temperature	32°F ~ 104°F (0°C ~ 40°C)
Dimensions	9.45inch x 5.39inch x 1.22inch
Storage Humidity	65±20%RH

4.2 – Charging the Swagboard



WARNING:

Before charging the Swagboard and/or its remote, you MUST turn off both devices and be sure to observe the following instructions.

- 1.Plug the charger into a grounded wall outlet (100V-240V; 50-60Hz).*
- 2.DO NOT attempt to operate or use the Swagboard and/or its remote while either is charging.*
- 3.Please keep your charging environment clean and dry.*
- 4.If the charging port is damp or has any liquid on it, DO NOT charge your Swagboard.*
- 5.In order for the battery to operate at maximum efficiency, avoid charging your Swagboard in*

extremely hot or extremely cold environments.

6. DO NOT charge the battery if there's excessive odor or heat and any leakage or physical damage.

When the Remote or Battery Indicator lights are flashing, the battery level is low and the Swagboard and/or remote need to be charged. When these Indicator lights remain steady, the batteries are fully or sufficiently charged.



WARNING:

+ If the battery will not be used for an extended period of time, fully charge and discharge it once every other month.

+ For your safety, only use the charger included with the Swagboard or received from Swagboard as a replacement.

+ Disregarding any of the above instructions may cause battery damage. Said damages are not covered under warranty.

+ Disassembly and battery maintenance should only be performed by an authorized professional. DO NOT touch or consume any substances leaking out of the battery. DO NOT allow children and animals to touch or consume the battery.

Section 5 – Safety Notice

Swagboard has been designed with the utmost safety for its riders. Extra precautions have been taken to protect the user from product hardware malfunctions through our meticulous design and engineering. However, like any riding product, the Swagboard has inherent hazards associated with its use (for example: losing control, falling off or riding into a hazardous situation). Therefore it is important to read and follow all instructions and warnings in the User Manual and use good judgment in order to ride safely.

By riding the Swagboard, the user acknowledges and accepts personal responsibility of all risks associated with the use of the Swagboard, which may include, but are not limited to, muscle injuries, broken bones, lacerations, or other serious injuries that may be sustained while using the Swagboard.

5.1 – Safe Riding Techniques

When operating, accelerating, decelerating, or braking, please keep your weight in line with the Swagboard direction in which you are going and in accordance with the functions you are performing in order to increase your stability and avoid possible product damage.

- If braking or decelerating forward, you should lean and/or shift weight slightly backwards.
- If starting or accelerating forward, you should lean and/or shift weight slightly forward.
- When atop the board, stand with feet apart so that your weight is more evenly distributed over the board. This will improve your stability.
- Wearing appropriate clothing and safety gear including knee pads, elbow pads, wrist braces, and an ASTM F1492 approved helmet is recommended for ALL riders of ALL ages at ALL times.
- Avoid wearing anything that can drape over or get caught into/under the wheels.
- Wear flat shoes to maintain flexibility and stability.
- Ensure the vehicle speed is safe to yourself and others, and be ready to stop at any time.
- When riding near others, keep a safe distance to avoid collisions.
- Be alert to your surroundings in order to ensure a safe ride. Your eyes are your best tool to safely avoid obstacles and slippery surfaces.
- Stay in open spaces and flat areas. Avoid steep slopes or high traffic areas until you're familiar with riding.

WARNING:



- + *Never ride at high speeds on uneven terrain or slopes.*
- + *Never perform stunts or turn abruptly without checking your surroundings.*
- + *Never carry one or more passengers on the Swagboard with you.*
- + *Never carry heavy items while riding.*
- + *Never ride in the rain, dark, or dimly lit areas.*

- + *Never use the Swagboard to do anything that may cause personal injury or property damage.*
- + *Never step off the Swagboard when it is in motion.*
- + *Never operate your Swagboard near flammable vapor, liquids, dust, or other fire hazards.*

FAILURE TO USE COMMON SENSE AND HEED THE ABOVE WARNINGS INCREASES THE RISK OF SERIOUS INJURY, OR IN VERY RARE CASES, DEATH. USE WITH APPROPRIATE CAUTION AND SERIOUS ATTENTION TO SAFE OPERATION.

5.2 – Battery Safety Usage Warnings

5.2.1 When Using the Battery

(1) Misusing the battery may cause the battery to get hot, rupture, or ignite and cause serious injury. Be sure to follow the safety rules listed below:

- Do not place the battery in fire or direct contact with heat.
- Do not pierce the battery with sharp objects, strike the battery, step on the battery, or otherwise subject it to strong impacts or shocks.
- Do not expose the battery to water or any liquids, or allow the battery to get wet.

(2) Do not disassemble or modify the battery. The battery contains safety and protection devices which, if damaged, may cause the battery to generate heat, rupture or ignite.

(3) Do not place the battery on or near fires, stoves, or other high-temperature locations. Do not place the battery in direct sunlight, or use or store the battery inside cars in hot or cold weather. Doing so may cause the battery to generate heat, rupture or ignite. Using the battery in this manner may also result in a loss of performance and a shortened life expectancy.



(1) If the device is to be used by children, the guardian should explain the contents of the user manual to the children. The guardian should provide adequate supervision to ensure that the device is being used as explained in the user manual.

(2) Immediately discontinue use of the battery if, while using, charging, or storing the battery, the battery emits an unusual smell, feels hot, changes color, changes shape, or appears abnormal in any other way.

(3) Do not place the batteries in microwave ovens, high-pressure containers, or on induction cookware.

(4) In the event that the battery leaks and the fluid gets into one's eye, do not rub the eye. Rinse well with water and immediately seek medical care. If left untreated, the battery fluid can cause damage to the eye.

5.2.2 While Charging

(1) Be sure to follow the rules listed below while charging the battery. Failure to do so may cause the battery to become hot, rupture or ignite and cause serious injury. When charging the battery, use a specified battery charger provided in the package. Do not place the battery in or near fire, or under the direct sunlight.

(2) Do not continue charging the battery if it does not recharge within the specified charging time. Doing so may cause the battery to become hot, rupture or ignite. The temperature range within which the battery can be charged is 32°F ~ 104°F (0°C to 40°C). Charging the battery at temperatures outside of this range may cause the battery to become hot or to break. Charging the battery outside of this temperature range may also harm the performance of the battery or reduce the battery's life expectancy.

5.2.3 When Discharging the Battery

Do not discharge the battery using any device except for the specified device. When the battery is used in devices aside from the specified device it may damage the performance of the battery or reduce its life expectancy, and if the device causes an abnormal current to flow, it may cause the battery to become hot, rupture or ignite and cause serious injury.



The temperature range within which the battery can be discharged is -4°F ~ 131°F (-20°C to 55°C). Use of the battery outside of this temperature range may damage the performance of the battery or reduce its life expectancy.

Section 6 – Important Information



TO PREVENT ELECTRIC SHOCK, MATCH THE WIDER PRONG OF PLUG TO WIDE SLOT IN OUTLET. FULLY INSERT.

FCC Regulations state that any unauthorized changes or modifications to this equipment not expressly approved by the manufacturer could void the user's authority to operate this equipment.

This product satisfies FCC Regulations when shielded cables and connectors are used to connect the unit to other equipment. To prevent electromagnetic interference with electric appliances such as radios and

televisions, use shielded cables and connectors for connections.

DECLARATION OF CONFORMITY:

This device complies with Part 15 of the FCC Rules.

Operation is subject to the following two conditions: (1) This device may not cause harmful interference, and (2) this device must accept any interference received, including interference that may cause undesired operation.

FCC RELATED INFORMATION:

This equipment has been tested and found to comply with the limits for a Class B digital device, pursuant to Part 15 of the FCC Rules. These limits are designed to provide reasonable protection against harmful interference in a residential installation. This equipment generates, uses, and can radiate radio frequency energy and, if not installed and used in accordance with the instructions, may cause harmful interference to radio communications. However, there is no guarantee that interference will not occur in a particular installation. If this equipment does cause harmful interference to radio or television reception, which can be determined by turning the equipment off and on, the user is encouraged to try to correct the interference by one or more of the following measures:

- + Reorient or relocate the receiving antenna.
- + Increase the separation between the equipment and receiver.
- + Connect the equipment into an outlet on a circuit different from that to which the receiver is connected.
- + Consult the dealer or an experienced radio/TV technician for help.

The manufacturer is not responsible for any radio or TV interference caused by unauthorized modifications to this equipment. Such modifications could void the user's authority to operate the equipment.

6.1 - DISPOSAL AT END-OF-LIFE

This product must not be disposed of by incineration, landfilling, or mixing with household trash. Improper disposal of the battery contained within this product may result in the battery heating up, rupturing, or igniting which may cause serious injury. The substances contained inside the battery present chemical risks to the environment. The recommended disposal for any Swagboard product at its end-of-life is to dispose of the entire unit at or through an e-Waste recycling center, program, or facility. Local regulations and laws pertaining to the recycling and disposal of lithium ion batteries and/or products containing them will vary according to country, state, and local governments. You must check laws and regulations corresponding to where you live in order to properly dispose of the battery and/or unit. It is the user's responsibility to dispose of their waste equipment properly with accordance with local regulations and laws.

For additional information about where you should drop off your batteries and electrical or electronic waste, please contact your local or regional waste-management office, your household waste disposal service, or your point-of sale.

1 Year Limited Hardware Warranty

Your Swagboard Voyager Electric Longboard ("Product") includes a One Year Limited Hardware Warranty ("Warranty"). The Warranty covers product defects in materials and workmanship under normal use. This Warranty is limited to residents of the United States and Canada only and is available only to original purchasers. This Warranty gives you specific legal rights and you may also have other rights which vary from state to state.

This Warranty starts on the date of your purchase and lasts for one year (the "Warranty Period"). The Warranty Period is not extended if the Product is repaired or replaced. We may change the availability of this limited warranty at our discretion, but any changes will not be retroactive.

Warranty services are provided by SWAGTRON. If a hardware defect arises and a valid claim is received within

the Warranty Period, at its option and to the extent permitted by law, SWAGTRON will: (1) repair the hardware defect by using new or refurbished parts that are equivalent to new in performance and reliability; or (2) exchange the Product with a product that is new or refurbished which is substantially equivalent to the original product. This Warranty is for one replacement only of like-items and does not cover items out of production if the product is no longer made or stocked. This Warranty is not assignable or transferable. The original purchaser may call SWAGTRON's toll-free number at 1-844-299-0625 for service request.

When a product or part is exchanged, any replacement item becomes your property and the replaced item becomes SWAGTRON's property. This warranty only covers technical hardware defectiveness during the warranty period and under normal use conditions. SWAGTRON does not warrant uninterrupted or error-free operation of this Product.

This Warranty does not cover any damage due to: (a) transportation; (b) storage; (c) improper use; (d) failure to follow the product instructions or to perform any preventive maintenance; (e) modifications; (f) unauthorized repair; (g) normal wear and tear; or (h) external causes such as accidents, abuse, or other actions or events beyond our reasonable control.

Important: Do not disassemble the Product. Disassembling the Product will void this Warranty. Only SWAGTRON or a party expressly authorized by SWAGTRON should perform service on this Product.

DISCLAIMER OF WARRANTY: THE REMEDIES DESCRIBED ABOVE ARE YOUR SOLE AND EXCLUSIVE REMEDIES AND OUR ENTIRE LIABILITY FOR ANY BREACH OF THIS LIMITED WARRANTY. OUR LIABILITY SHALL UNDER NO CIRCUMSTANCES EXCEED THE ACTUAL AMOUNT PAID BY YOU FOR THE DEFECTIVE PRODUCT, NOR SHALL WE UNDER ANY CIRCUMSTANCES BE LIABLE FOR ANY CONSEQUENTIAL, INCIDENTAL, SPECIAL OR PUNITIVE DAMAGES OR LOSSES, WHETHER DIRECT OR INDIRECT.

SOME STATES DO NOT ALLOW THE EXCLUSION OR LIMITATION OF INCIDENTAL OR CONSEQUENTIAL DAMAGES, SO THE ABOVE LIMITATION OR EXCLUSION MAY NOT APPLY TO YOU.

THE DURATION AND REMEDIES OF ALL IMPLIED WARRANTIES, INCLUDING WITHOUT LIMITATION THE WARRANTIES OF MERCHANTABILITY AND FITNESS FOR A PARTICULAR PURPOSE ARE LIMITED TO THE DURATION OF THIS EXPRESS LIMITED WARRANTY.

SWAGBOARD™